

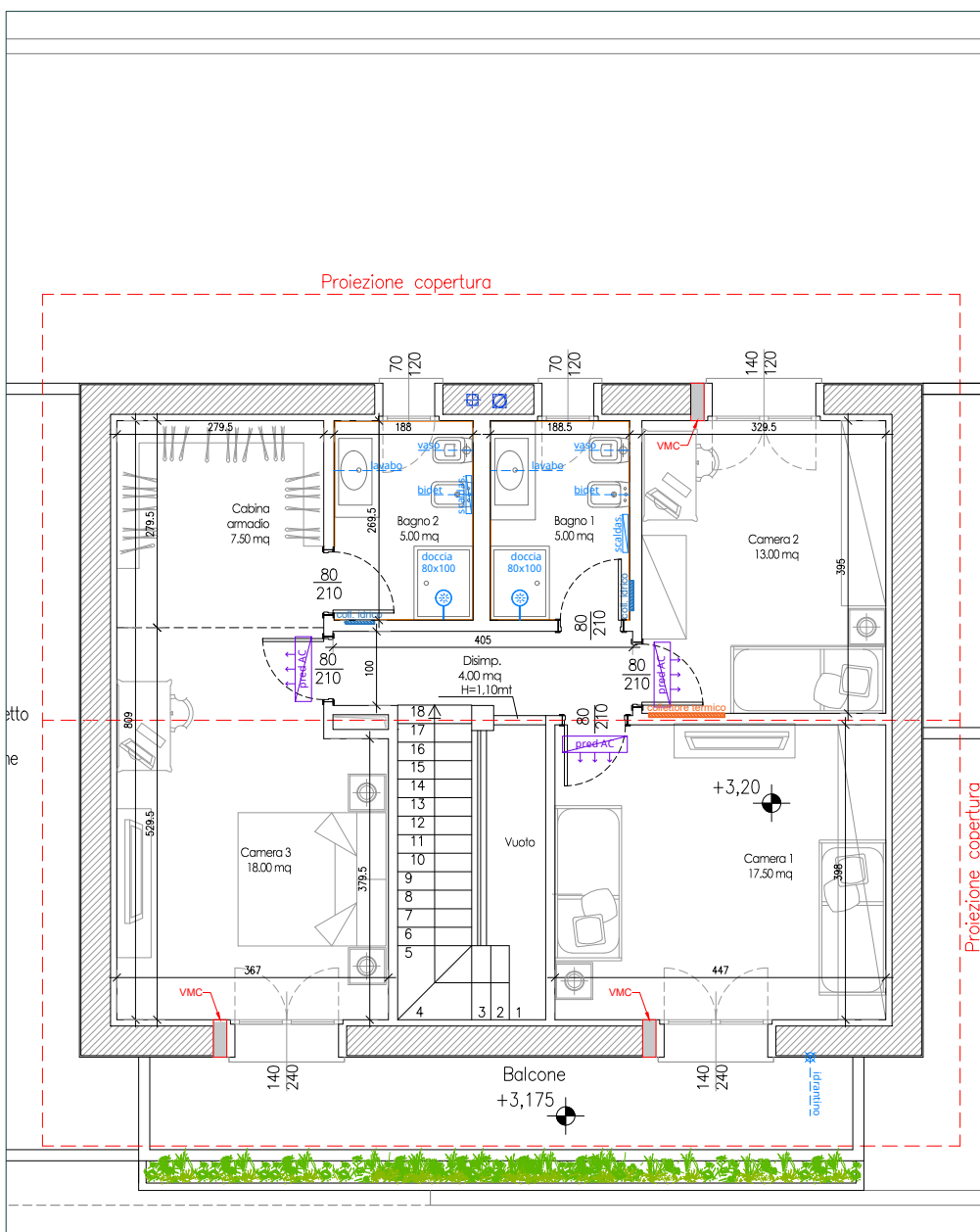









piano TERRA

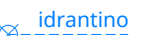

piano PRIMO

-  superficie commerciale **175.07 mq**
-  superficie box **36.43 mq**
-  camere **3**
-  bagni **3**
-  superficie giardino **74.40 mq**
-  superficie balconi **13.71 mq**
-  superficie portici **14.15 mq**
-  tipologia **villa singola**
-  classe energetica **A++++**

- LEGENDA:
-  collettore termico
 -  collettore idrico
 -  scaldaserviette elettrico
 -  Split idronico A/C
 -  predisposizione A/C per split idronici
 -  rinforzi previsti per cartongesso h. 200/300
 -  solo adduzione acqua fredda
 -  quadro elettrico

N.B.: le misure sono da considerarsi PURAMENTE indicative e saranno sottoposte a verifica tecnico-reliziativa

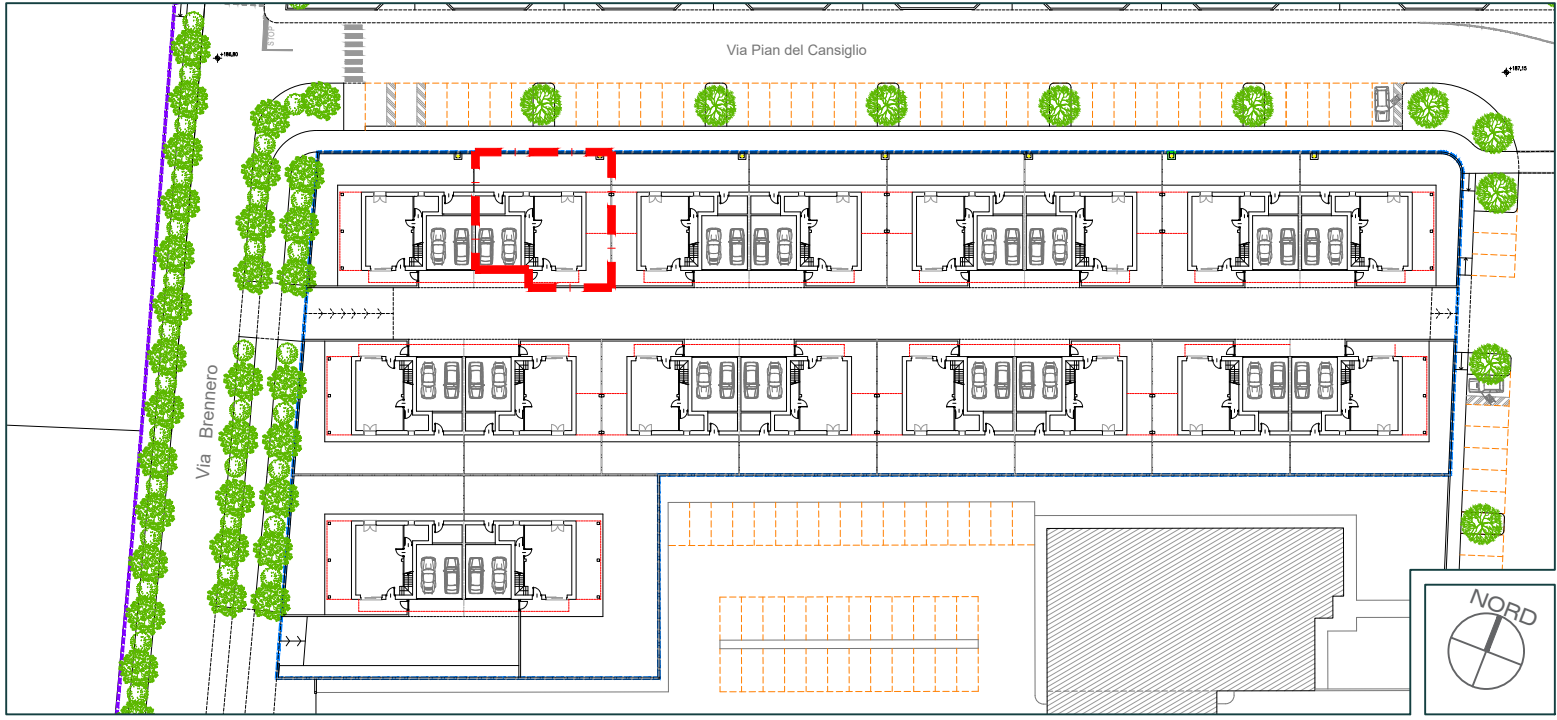

localizzazione nel LOTTO